

GROUND FASTENING LAYOUT (SECTION A-A)

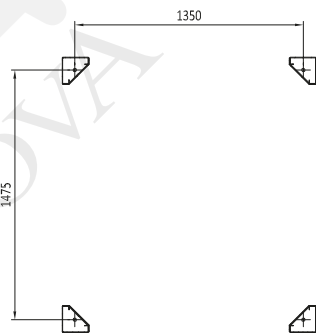

INLET FLANGE DETAIL

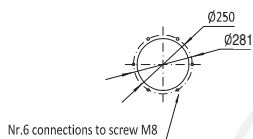

OUTLET FLANGE DETAIL

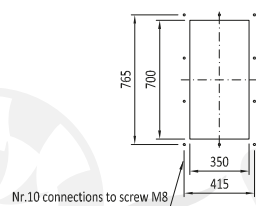

TECHNICAL SPECIFICATIONS

ITEM CODE		OPF-P 3300	
Weight	kg	1100	
Number of filtering elements	nr	4	
Filtering surface	m ²	84	
Filtering efficiency	99,999% on 0,5 micron dust particles		
Max working negative pressure	Pa	5000	
Working Temperature	°C	-10<T<40	
Pneumatic feeding (ISO Class 2.4.1 according 8573-1:2010)	Ø	12	
Electric feeding	400 V - 50 Hz		
Cartridge cleaning system	pulse-jet		
Number of cleaning valves	nr	4	
Type of cleaning valves	Ø 1" - 24 V DC		
Compressed air tank working pressure	bar	5,5	
PERFORMANCE CHARACTERISTICS			
Nominal air flow	m ³ /h	3300	
Nominal static pressure	Pa	3340	
Nominal fan power	kW	5,5	
Max compressed air consumption	Nl/min	360	

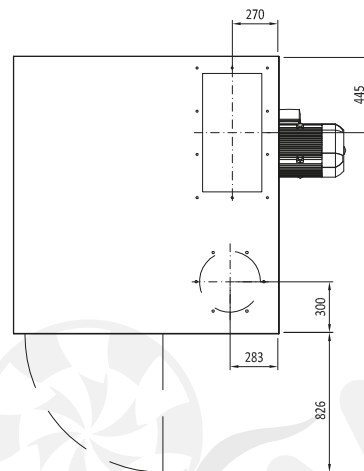
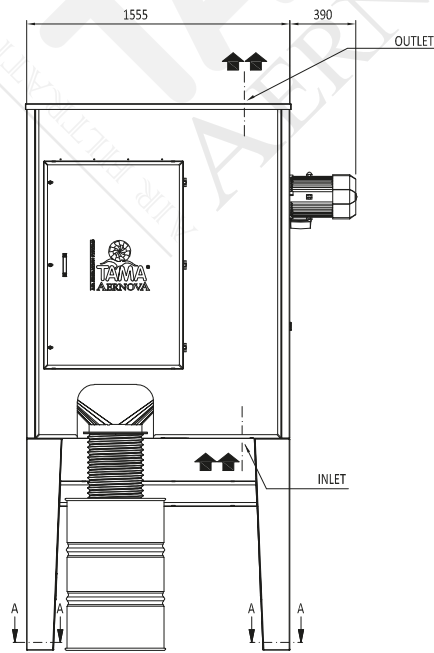
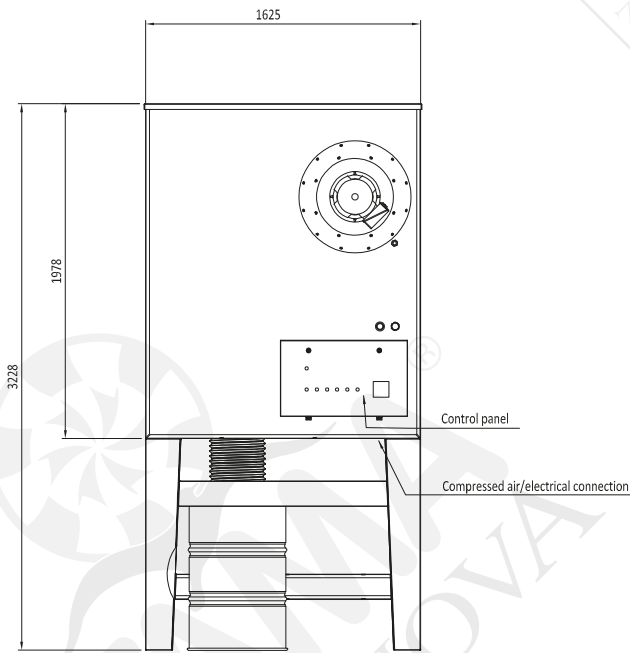

GROUND FASTENING LAYOUT (SECTION A-A)

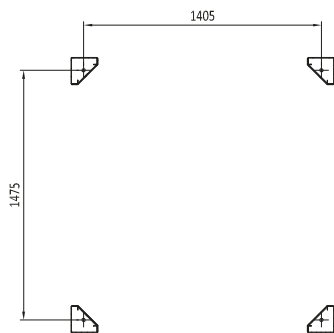

INLET FLANGE DETAIL

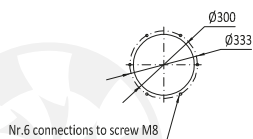

OUTLET FLANGE DETAIL

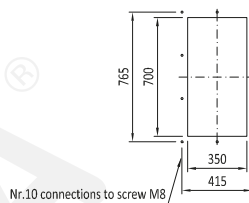

TECHNICAL SPECIFICATIONS

ITEM CODE		OPF-P 5000	
Weight	kg		1200
Number of filtering elements	nr		6
Filtering surface	m ²		126
Filtering efficiency	99,999% on 0,5 micron dust particles		
Max working negative pressure	Pa		5000
Working Temperature	°C		-10<T<40
Pneumatic feeding (ISO Class 2.4.1 according 8573-1:2010)	Ø		12
Electric feeding	400 V - 50 Hz		
Cartridge cleaning system	pulse-jet		
Number of cleaning valves	nr		6
Type of cleaning valves	Ø 1" - 24 V DC		
Compressed air tank working pressure	bar		5,5
PERFORMANCE CHARACTERISTICS			
Nominal air flow	m ³ /h		5000
Nominal static pressure	Pa		3400
Nominal fan power	kW		7,5
Max compressed air consumption	Nl/min		360

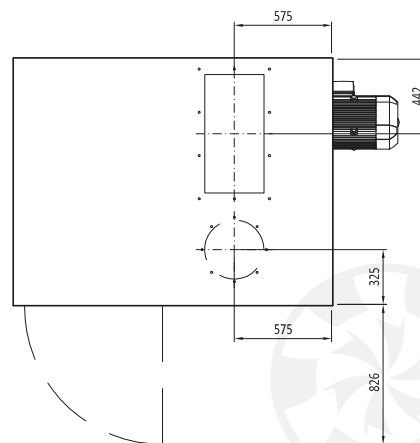
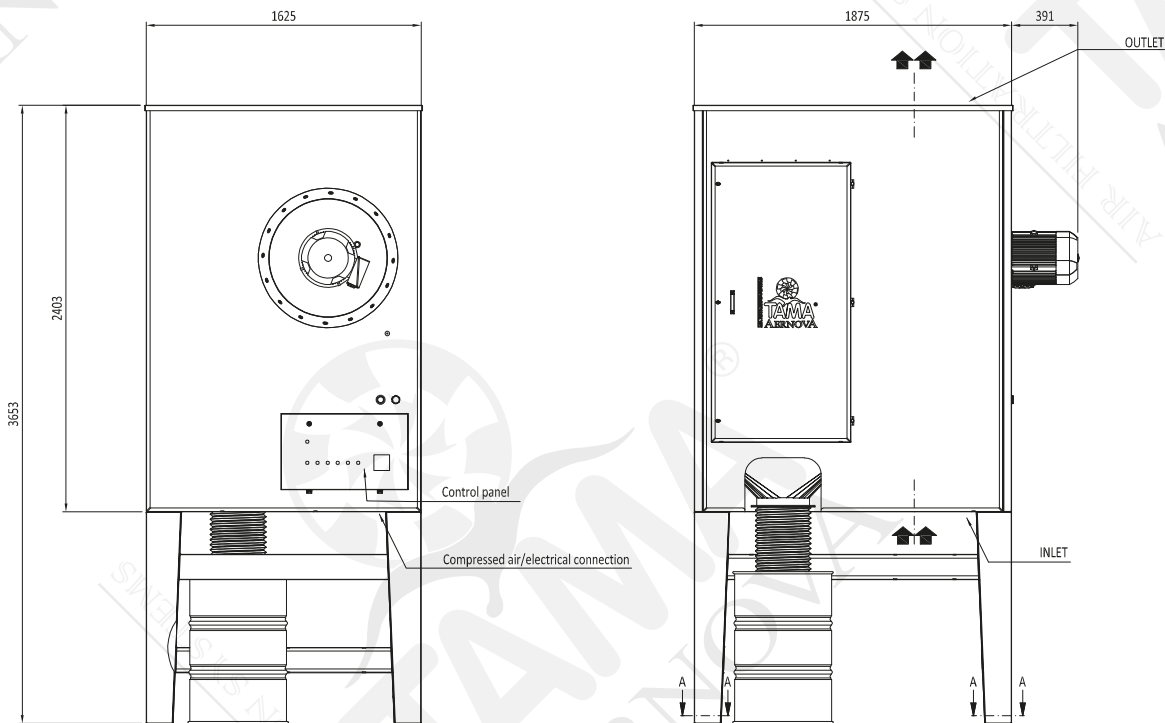

GROUND FASTENING LAYOUT (SECTION A-A)

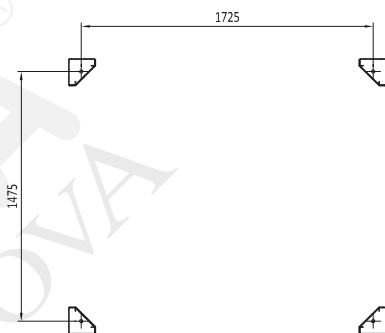

INLET FLANGE DETAIL

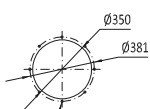

Nr.8 connections to screw M8

OUTLET FLANGE DETAIL

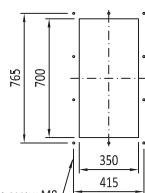

Nr.10 connections to screw M8



TECHNICAL SPECIFICATIONS

ITEM CODE	OPF-P 6600	
Weight	kg	1600
Number of filtering elements	nr	8
Filtering surface	m ²	168
Filtering efficiency	99,999% on 0,5 micron dust particles	
Max working negative pressure	Pa	5000
Working Temperature	°C	-10<T<40
Pneumatic feeding (ISO Class 2.4.1 according 8573-1:2010)	Ø	12
Electric feeding	400 V - 50 Hz	
Cartridge cleaning system	pulse-jet	
Number of cleaning valves	nr	8
Type of cleaning valves	Ø 1" - 24 V DC	
Compressed air tank working pressure	bar	5,5
PERFORMANCE CHARACTERISTICS		
Nominal air flow	m ³ /h	6600
Nominal static pressure	Pa	3550
Nominal fan power	kW	11
Max compressed air consumption	Nl/min	360

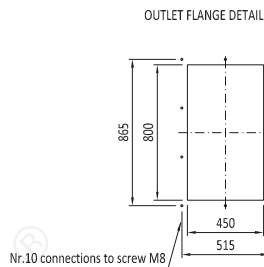
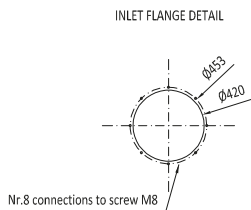
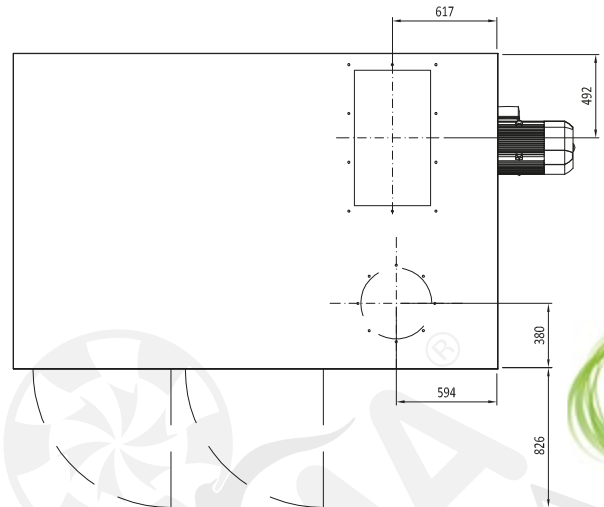
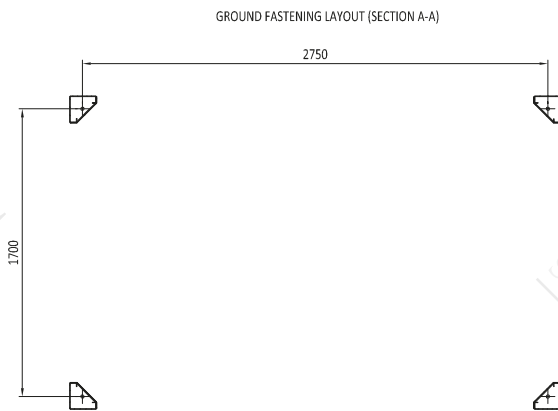
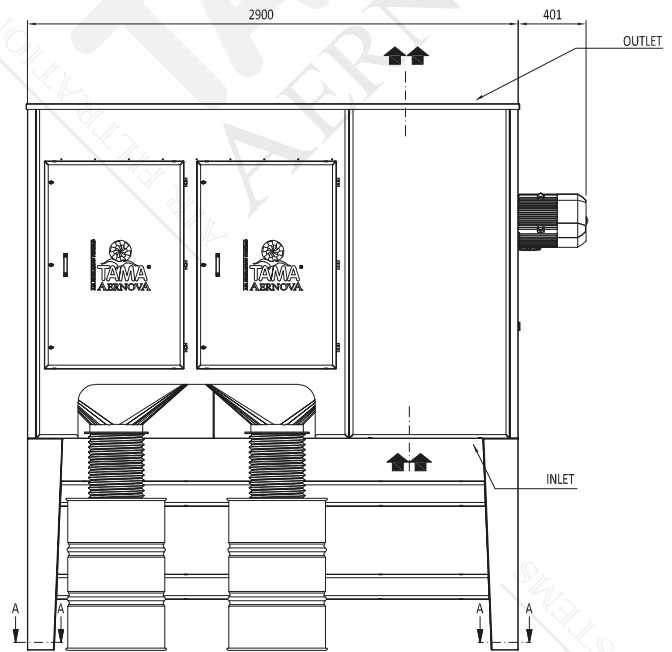
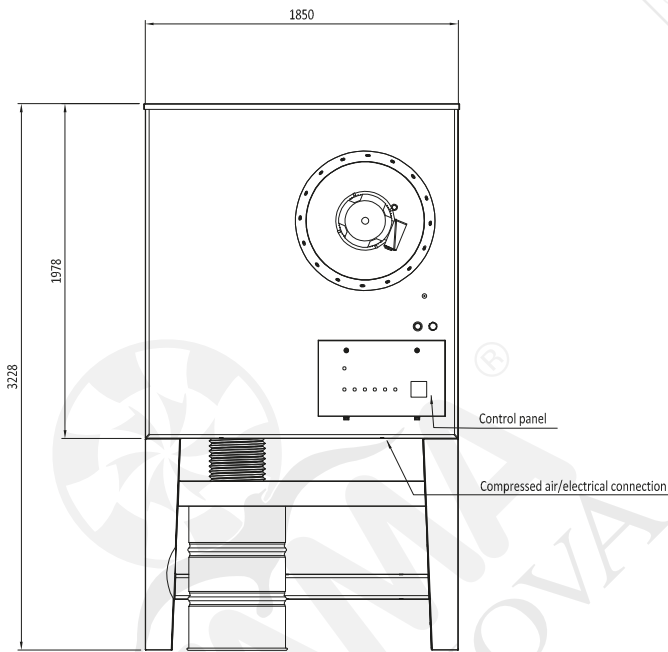

TECHNICAL SPECIFICATIONS			
ITEM CODE	OPF-P 10000		
Weight	kg		1750
Number of filtering elements	nr		12
Filtering surface	m ²		252
Filtering efficiency	99,999% on 0,5 micron dust particles		
Max working negative pressure	Pa		5000
Working Temperature	°C		-10<T<40
Pneumatic feeding (ISO Class 2.4.1 according 8573-1:2010)	Ø		12
Electric feeding	400 V - 50 Hz		
Cartridge cleaning system	pulse-jet		
Number of cleaning valves	nr		12
Type of cleaning valves	Ø 1" - 24 V DC		
Compressed air tank working pressure	bar		5,5
PERFORMANCE CHARACTERISTICS			
Nominal air flow	m ³ /h		9900
Nominal static pressure	Pa		3500
Nominal fan power	kW		15
Max compressed air consumption	Nl/min		360

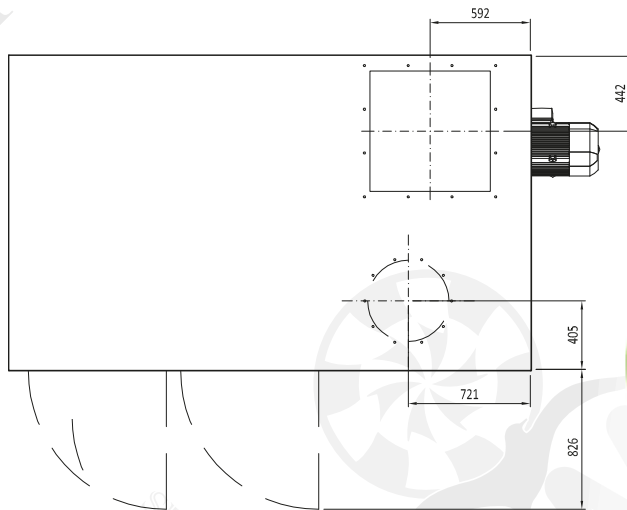
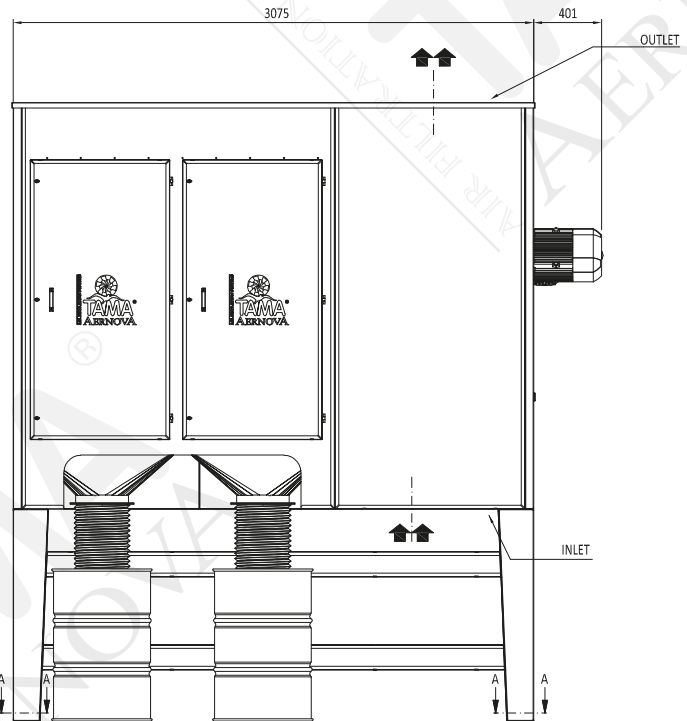
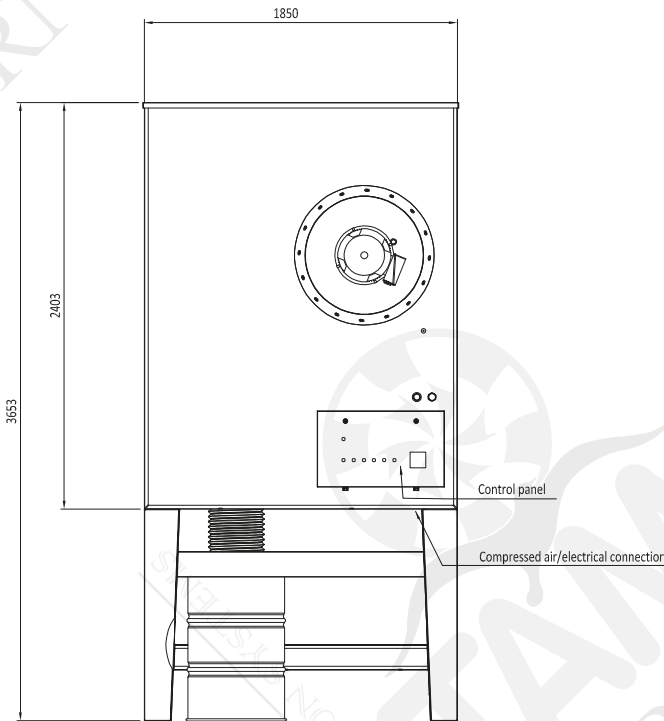

GROUND FASTENING LAYOUT (SECTION A-A)



INLET FLANGE DETAIL

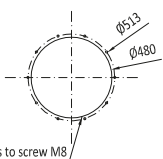

OUTLET FLANGE DETAIL

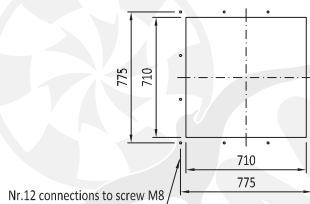

TECHNICAL SPECIFICATIONS

ITEM CODE	OPF-P 13200	
Weight	kg	2100
Number of filtering elements	nr	16
Filtering surface	m ²	336
Filtering efficiency	99,999% on 0,5 micron dust particles	
Max working negative pressure	Pa	5000
Working Temperature	°C	-10<T<40
Pneumatic feeding (ISO Class 2.4.1 according 8573-1:2010)	∅	12
Electric feeding	400 V - 50 Hz	
Cartridge cleaning system	pulse-jet	
Number of cleaning valves	nr	16
Type of cleaning valves	∅ 1" - 24 V DC	
Compressed air tank working pressure	bar	5,5
PERFORMANCE CHARACTERISTICS		
Nominal air flow	m ³ /h	13200
Nominal static pressure	Pa	3600
Nominal fan power	kW	18,5
Max compressed air consumption	NI/min	360